

Type CD43 (1 ~ 68) μ H

- # Ferrite core
- # High S.R.F.
- # smd mounting
- # Miniature size

The type CD43 smd inductors provide high inductance and rated d.c. current with very small size. They are high quality components which may be assembled using reflow or wave soldering techniques and supplied packed in bulk or on 12mm tape and reel, 1500 pieces per reel. Maximum rated current is based on a temperature rise of +40°C and a maximum inductance fall to 80% of the original value.

Electrical specification

Inductance range	(1 ~ 68) μ H at 2.52MHz
Core material	Ferrite
Temperature range	(-25 +70)°C
Moisture resistance	H \pm 5% max., Q \pm 10% max., relative humidity 90% ~ 95%, +40°C, 24 hours
Marking	Date code, inductance code

Dimensions(mm)

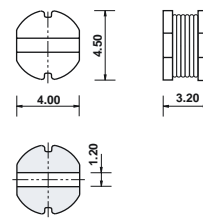

Connections are tinned
Suitable for reflow or wave soldering
Connections viewed from bottom
Core material is ferrite

Suggested land pattern

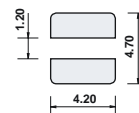

Insulation resistance	100M Ω min.
Voltage rating	100Vd.c.
Temperature coefficient	(0 ~ 2000)ppm/°C
Vibration	\pm 2% max. (10 ~ 55)Hz, 1.5mm displacement, three planes, duration 1 hour
Shock	\pm 2% max., three shocks of 100g, each of three planes

TFC Part No.	Inductance Code	Value	Ω d.c. max.	d.c. current Amps max.	s.r.f. min. MHz
CD43 - 1R0MC	10M	1 μ H \pm 20%	0.049	2.56	113.8
CD43 - 1R4MC	14M	1.4 μ H \pm 20%	0.056	2.52	101
CD43 - 1R8MC	18M	1.8 μ H \pm 20%	0.064	1.95	92
CD43 - 2R2MC	22M	2.2 μ H \pm 20%	0.071	1.75	76.8
CD43 - 2R7MC	27M	2.7 μ H \pm 20%	0.079	1.58	66.6
CD43 - 3R3MC	33M	3.3 μ H \pm 20%	0.086	1.44	63.8
CD43 - 3R9MC	39M	3.9 μ H \pm 20%	0.094	1.33	53.8
CD43 - 4R7MC	47M	4.7 μ H \pm 20%	0.109	1.15	49.5
CD43 - 5R6MC	56M	5.6 μ H \pm 20%	0.126	0.99	43.2
CD43 - 6R8MC	68M	6.8 μ H \pm 20%	0.131	0.95	41.4
CD43 - 8R2MC	82M	8.2 μ H \pm 20%	0.146	0.84	36.8
CD43 - 100MC	100M	10 μ H \pm 20%	0.182	1.04	35.8
CD43 - 120MC	120M	12 μ H \pm 20%	0.210	0.97	32.4
CD43 - 150MC	150M	15 μ H \pm 20%	0.235	0.85	29.3
CD43 - 180MC	180M	18 μ H \pm 20%	0.338	0.74	27.5
CD43 - 220MC	220M	22 μ H \pm 20%	0.378	0.68	24.7
CD43 - 270MC	270M	27 μ H \pm 20%	0.522	0.62	21.7
CD43 - 330KC	330K	33 μ H \pm 10%	0.540	0.56	19.6
CD43 - 390KC	390K	39 μ H \pm 10%	0.587	0.52	18.0
CD43 - 470KC	470K	47 μ H \pm 10%	0.844	0.44	15.6
CD43 - 560KC	560K	56 μ H \pm 10%	0.937	0.42	14.8
CD43 - 680KC	680K	68 μ H \pm 10%	1.117	0.37	13.2