

Type CMC (SMD type) (25 ~ 1600) μ H

- # Frequency range up to 100MHz
- # Meets UL94V-0 flammability standard
- # Provides 300vdc isolation
- # RoHS Compliant

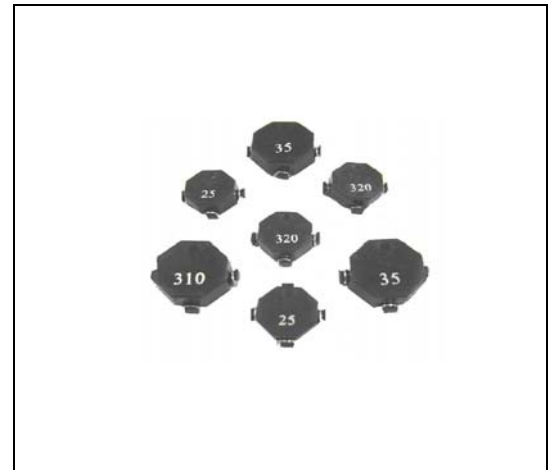

TFC Part Number	Open Circuit Inductance μ H +/-25%	I rms max Amperes	DCR $m\Omega$ typ	Lk μ H max	Capacitance pF typ
SMT-CMC02-01P	25	5.35	3.10	0.22	2.00
SMT-CMC02-02P	40	4.40	3.89	0.34	2.30
SMT-CMC02-03P	70	3.60	5.35	0.47	2.50
SMT-CMC02-04P	95	2.80	7.96	0.80	2.80
SMT-CMC02-05P	150	2.30	16.85	1.25	3.10
SMT-CMC02-06P	275	1.85	34.53	1.75	3.40
SMT-CMC02-07P	320	1.60	39.72	2.00	3.60
SMT-CMC02-08P	400	1.35	42.73	2.60	3.90
SMT-CMC02-09P	500	1.10	57.43	3.30	4.10
SMT-CMC02-10P	620	0.94	73.72	4.00	4.30
SMT-CMC02-11P	750	0.80	98.34	5.00	4.60
SMT-CMC02-12P	1100	0.67	161.20	6.30	4.90
SMT-CMC02-13P	1300	0.58	245.50	7.30	5.10
SMT-CMC02-14P	1600	0.50	350.50	9.00	5.40
SMT-CMC03-01P	35	5.70	4.63	0.31	2.80
SMT-CMC03-02P	50	5.10	5.12	0.46	3.05
SMT-CMC03-03P	75	4.75	6.52	0.64	3.30
SMT-CMC03-04P	105	3.95	7.92	0.85	3.50
SMT-CMC03-05P	175	3.10	15.9	1.30	3.70
SMT-CMC03-06P	260	2.85	19.5	1.90	3.90
SMT-CMC03-07P	310	2.45	25.3	2.20	4.15
SMT-CMC03-08P	420	2.00	36.8	3.00	4.40
SMT-CMC03-09P	480	1.70	50.2	3.30	4.65
SMT-CMC03-10P	620	1.45	62.1	4.20	4.85
SMT-CMC03-11P	780	1.20	92.3	5.10	5.10
SMT-CMC03-12P	950	1.05	132.1	6.10	5.35
SMT-CMC03-13P	1250	0.88	192.2	7.80	5.55
SMT-CMC03-14P	1600	0.75	286.5	9.60	5.80

SMT-CMC02 drawing (mm)

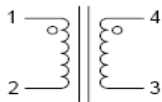
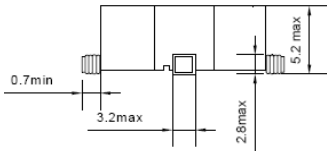
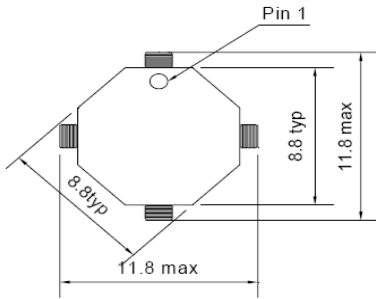

SMT-CMC03 drawing (mm)

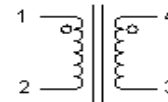
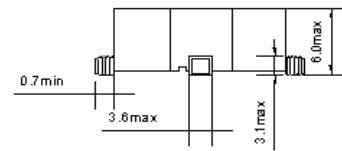
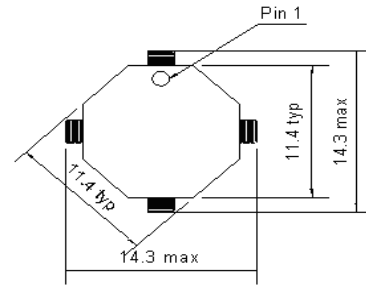

Ordering information
SMT-CMC2-01P

SMT	C	MC02	-	01	P
(1)	(2)	(3)	(4)		

- (1) **Type:** Surface Mountable Type
- (2) **Style:** CMC02, 02 is 8.8mm x11.8mm and is about 3.2mm height
- (3) **Inductance:** 01=25 μ H see table
- (4) **Inductance tolerance:** P: \pm 25%

Electrical specification

Inductance range	SMT-CMC02 25 ~ 1600 μ H SMT-CMC03 35 ~1600 μ H
OCL(1-2/4-3)	100KHz, 0.1V, 0A (See Chart)
DCR (1-2/4-3)	typical @20 $^{\circ}$ C (See Chart)
Turns ratio	(1-2): (4-3) = 1:1
Operating temperature	-40 $^{\circ}$ C to 85 $^{\circ}$ C
Hipot Test	Windings to Windings : 300Vdc for 1 second